

SKETCH PLAN

SHOWING PROPOSED SUBDIVISION OF LOT 21 IN DP 785503
 PARISH OF NORWAY
 COUNTY OF WESTMORELAND
 LOCALITY OF TITANIA PARK
 L.G.A. OBERON

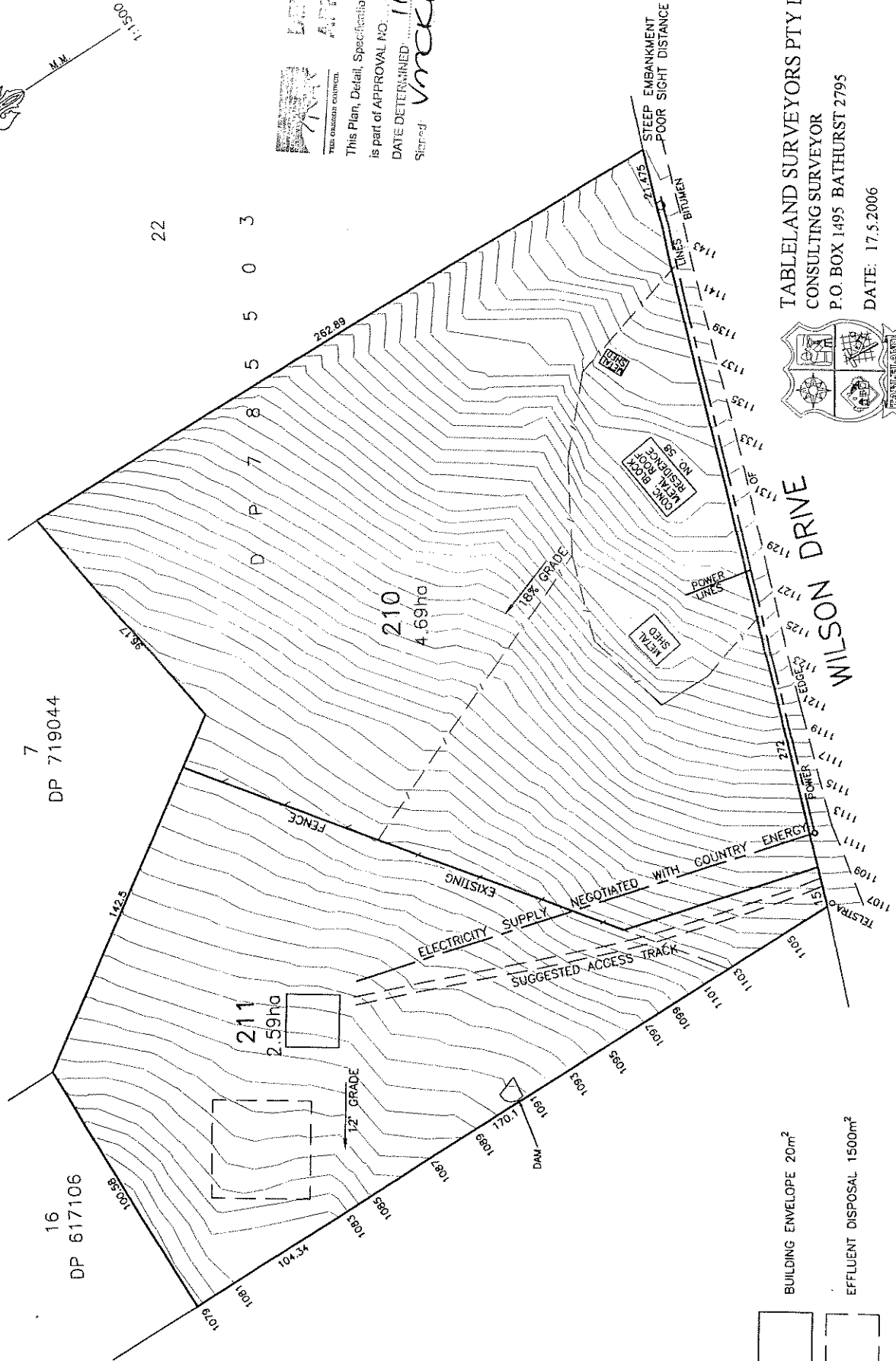

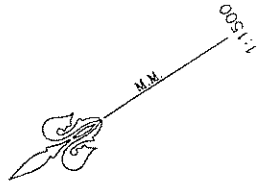

DEVELOPMENT APPLICATION

This Plan, Detail, Specification, and/or Documentation is part of APPROVAL NO. **233/06**
 DATE DETERMINED: **11/7/06**
 Signed: *MCKINNON*

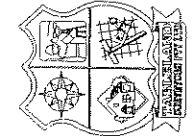
TABLELAND SURVEYORS PTY LTD
 CONSULTING SURVEYOR
 P.O. BOX 1495 BATHURST 2795
 DATE: 17.5.2006
 REFERENCE: CG05/463D



-  BUILDING ENVELOPE 20m²
-  EFFLUENT DISPOSAL 1500m²